



- Flame Flashback Prevention
- High Flow Capacity
- Standard SS
- Sizes 1/4" Through 2"
- 25 PSIG Working Pressure

## The Shand & Jurs Model 97200 Flame Check

The S&J 97200 Flame Check provides an in-line barrier against flame flashback in small gas lines. They are typically installed in pilot lines supplying fuel burning devices used in flares and waste gas burners. They are also used in vent piping servicing manometer pressure taps and diaphragm regulators.

Optimally, the flame check should be located as close as possible to the open end of the vent pipe or to the potential source of the flame. The flame check quenches in-line fires by lowering the gas temperature to below its ignition point. The 97200 provides safe, reliable fire protection with a woven wire design.

The flame check allows maximum flow with minimal pressure drop. It is also easily serviced and installed with pipe union housing.

Its aluminum and stainless steel components withstand the severest of process environments. The S&J 97200 is especially designed for hydrogen sulfide and hot, wet methane which are the main components of digester gas streams in municipal waste water treatment facilities.

The 97200 is 100% U.S. made.

## Applications

**Anaerobic digester gas train**  
**Fermentation off gas piping systems**  
**Low pressure vent lines**

SIZE Code		1	2	3	4	5	6
<b>D</b>	<b>Nominal Pipe Size</b>	1/4	1/2	3/4	1	1 1/2	2
<b>W</b>	<b>Width</b>	2	3 1/2	3 1/2	3 1/2	4 3/4	4 3/4
<b>L</b>	<b>Length</b>	3	3 1/2	3 1/2	3 1/2	4 1/2	4 1/2
<b>Shipping Weight</b>		1	2	2	3	3	4

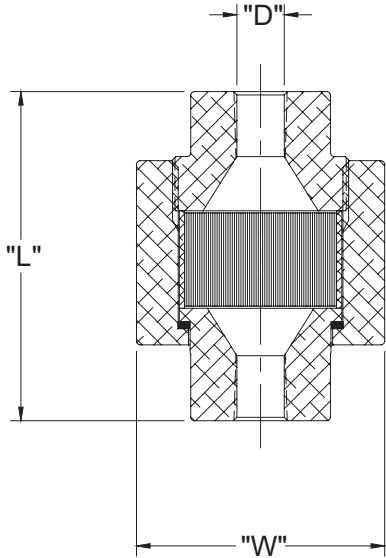

**AIR FLOW CAPACITY IN STANDARD CUBIC FEET PER HOUR**

Pressures Inches W.C.	Line Diameter					
	1/4"	1/2"	3/4"	1"	1-1/2"	2"
0.25	39	54	78	148	316	886
0.50	62	91	129	260	536	1430
0.75	80	124	176	353	716	1877
1.00	96	151	213	443	892	2236
1.25	107	175	247	519	1032	2562
1.50	117	193	271	596	1165	2863
1.75	126	204	294	659	1288	3115
2.00	133	213	311	720	1395	3279

**HOW TO ORDER**

**97200 - AB**

Line Size and Connection \_\_\_\_\_ | \_\_\_\_\_ Element Material

<p><u>(A) Size and Connection</u></p> <p>1 = 1/4" NPT</p> <p>2 = 1/2" NPT</p> <p>3 = 3/4" NPT</p> <p>4 = 1" NPT</p> <p>5 = 1 1/2" NPT</p> <p>6 = 2" NPT</p>	<p><u>(B) Element / Body Material</u></p> <p>1 = 316 SS / 316 SS</p> <p>2 = 316 SS / AL</p>
---	---

All designs subject to change. Certified dimensions and specifications available upon request.